

Fifteen-foot utility easement

Truck Door 14' high

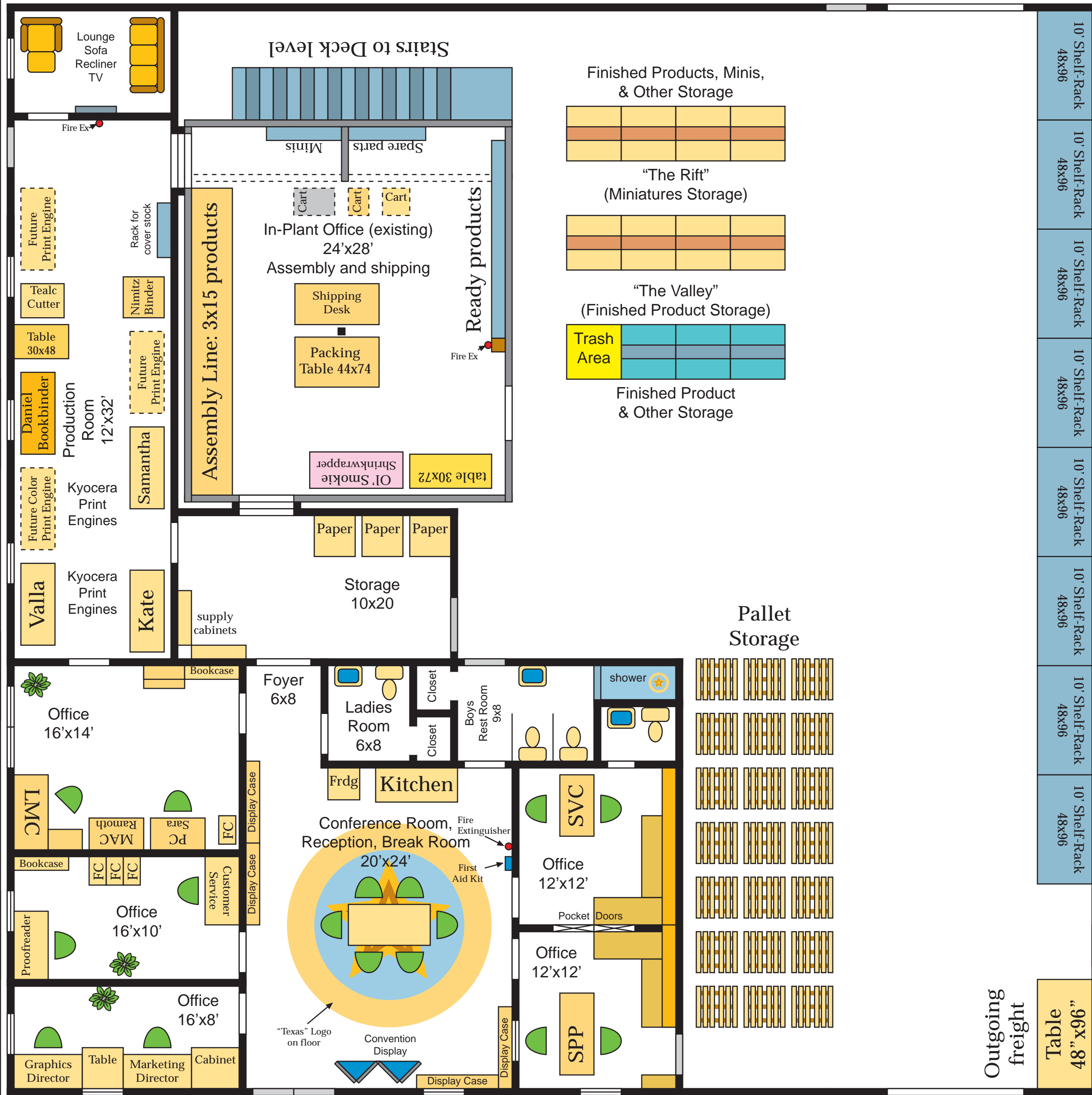

Notes:

- Most doors to be 36" HC (solid doors on outside and to warehouse). Most doors will have glass upper panels.
- Two four-ton heaters (over office) and two three-ton air conditioners (outside) with common plenum. Most of the time, only one runs. System is to include humidifier.
- Deck over office has 2x10 joists and plywood deck for medium load bearing. Deck over assembly room is steel & plywood heavy-load mezzanine (existing).
- Windows high on all four walls to allow natural light into warehouse (instead of skylights).

Warehouse
 Total = 3800 SF

Office 60'x32'
 Total = 2600

Total structure
 80'x80'
 6400 SF

Parking lot for
 14 cars, more
 landscaping,
 and truck
 access.



Front Doors

Sidewalks, landscaping, parking

Truck Door 14' high